

SORTIE ECHAPPEMENT / EXHAUST OUTLET
(Détail contre-bride / counter-flange detail)

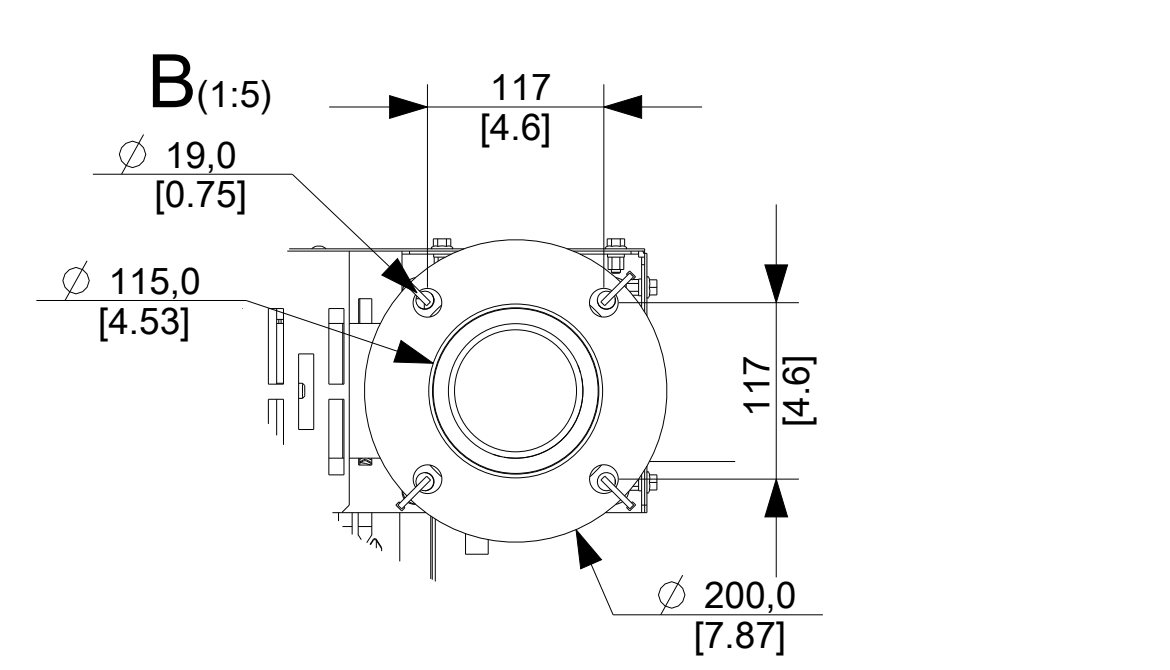

MOTEUR / ENGINE	ALTERNATEUR / ALTERNATOR	MASSE / WEIGHT (kg / lbs) +/- 5%		COG (mm / inch) A vide / Dry		COG (mm / inch) OdM / Wet	
		A vide / Dry	OdM / Wet	CG Horizontal	CG Vertical	CG Horizontal	CG Vertical
DOOSAN DP180LB	KH3546T	5188 / 11437	7282 / 16054	3313 / 130.43	858 / 33.77	3261 / 128.38	901 / 35.47
DOOSAN DP180LB	KH2954T	4961 / 10937	7056 / 15555	3270 / 128.73	851 / 33.50	3229 / 127.12	897 / 35.31
DOOSAN DP180LB	KH02713T	4879 / 10756	6974 / 15375	3260 / 128.34	849 / 33.42	3221 / 126.81	896 / 35.27

Voir folios suivants pour informations complémentaires / See following sheets for additional informations.

CET ASSEMBLAGE OU PIECE DOIT ETRE CONFORME A LA SPECIFICATION PEP-RML-001
THIS ASSEMBLY OR PART MUST COMPLY WITH SPECIFICATION PEP-RML-001

REV	DATE	ON COMPOSITE DWGS. SEE PART NO. FOR REVISION LEVEL	BY	DO NOT SCALE. REFERENCE THE MODEL FOR ALL UNSPECIFIED DIMENSIONS
-	07/06/22	NEW DRAWING	SP	UNLESS OTHERWISE SPECIFIED - 1) DIMENSIONS ARE IN MILLIMETERS 2) TOLERANCES ARE: NF ISO1300-A4E
A	14/03/24	UPDATE	SP	

APPROVALS DATE: 14-Mar-24
P. SIMON

TITLE: 30001546201
CAD NO: 30001546201
DWG NO: 30001546201

SCALE: 1:10
SHEET: 1 of 3
REV: A
SIZE: A0

270 rue de Kerenenn - 29490 Guipavas
CS 40047 - 29801 Brest Cedex 9 - France

THIS DRAWING IS UNDER PROPERTY OF THE COMPANY.
IT CANNOT BE PRINTED, USED OR COMMUNICATED WITHOUT ITS AUTHORIZATION.

